

# Trex® Horizons Composite Fencing

SRF Fence & Supply Co.

**Trex®**  
Fence Distribution

Trex Company National Distribution Partner

ARCHITECTURAL DRAWING:  
TREX FENCING HORIZONS  
8' TALL X 8' WIDE

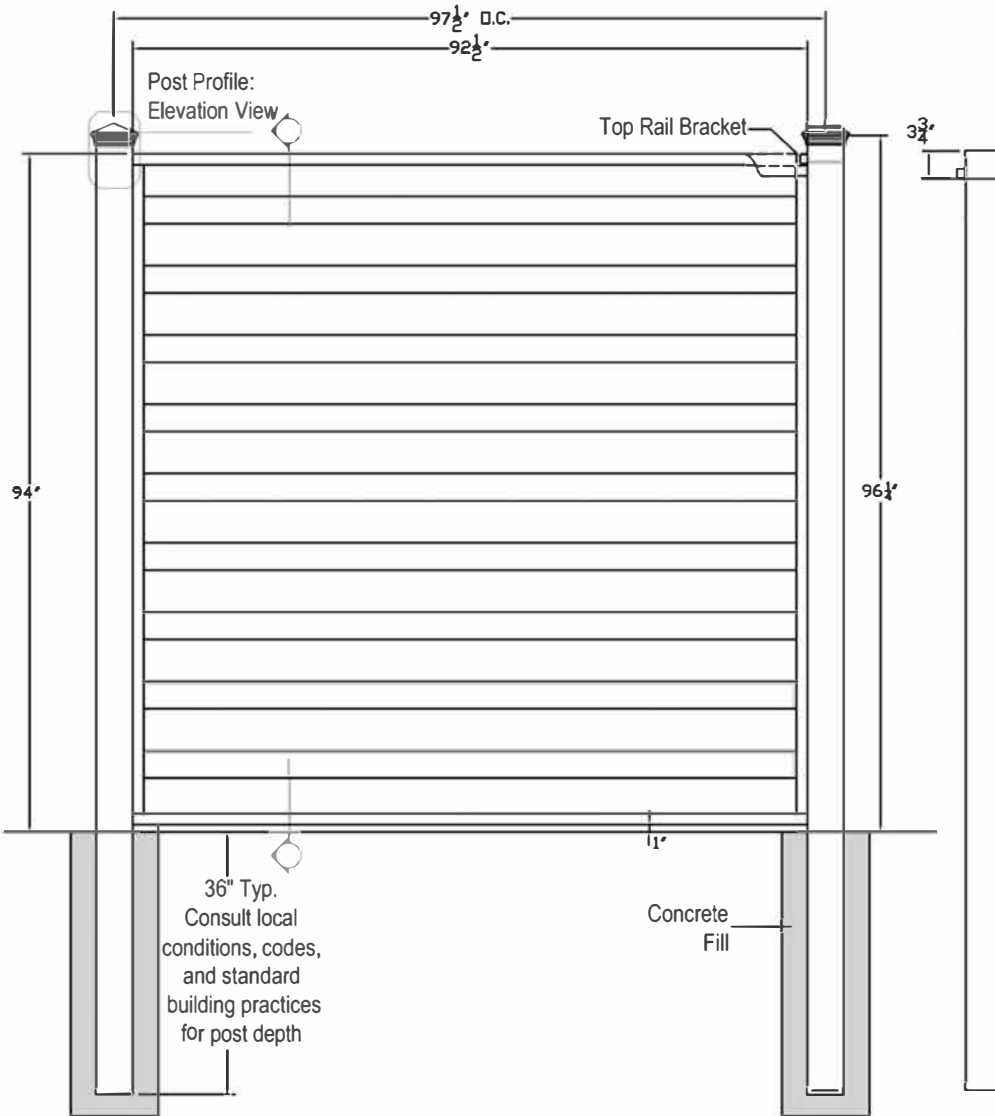

COMPONENTS	QUANTITY	LENGTH
Post Cap: Pyramid, Flat,	1	
5" x 5" Composite Post	1	144"
1.5" x 1.25" Horizontal Rail	2"	92"
1"x5.75" Interlocking Picket	19	91" *
0.875" x 1.5" Vertical Back Rail	4	93"
0.5" x 1.5" Vertical Front Rail	4	93"
1.25" x 1.125" Horizontal Top Rail Bracket	2	1"

\* Length may vary

SCREWS	DIRECTIONS
#12-11 X 1" Large Black Hex Head Screw	Used for mounting brackets and vertical rails to post
#8-15 X 5/8" Small Black Hex Head Screw	Used for attaching horizontal and vertical front rails to pickets
#8-18 X 3/4" Self Tapping Black Hex Head Screw	Used for attaching vertical rails to horizontal rails in corners

1. INSTALLATION TO BE COMPLETED PER MANUFACTURER'S SPECIFICATION.
2. THIS DRAWING IS PROVIDED FOR PLANNING PURPOSES. REFER TO MANUFACTURER'S INSTALLATIONS FOR CONSTRUCTION DETAILS.
3. REFER TO MANUFACTURER'S WEBSITE FOR PRODUCT INFORMATION.
4. DRAWING NOT TO SCALE.
5. CUTTING HORIZONS STEEL RAILS REQUIRES RECOATING WITH PAINT

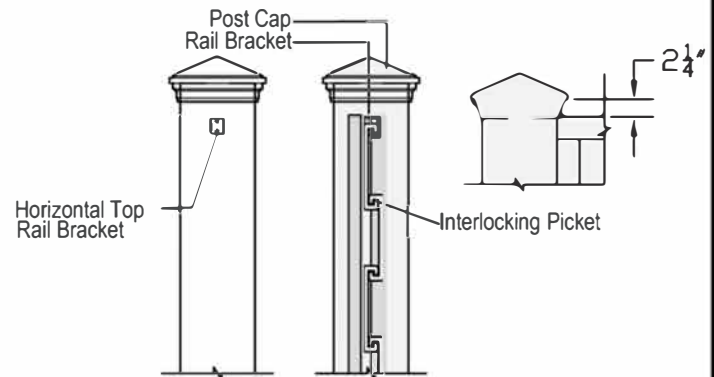

Post Profile: Cut View / Elevation View

SRF Fence & Supply Co.

**Trex®**  
Fence Distribution

[www.buytrexfencing.com](http://www.buytrexfencing.com)  
855.620.TREX (8739)  
SRF Fence & Supply Co.  
1745 Shea Center Dr., Ste. 370  
Highlands Ranch, CO 80129

Trex® and the Trex® logo are either federally registered trademarks, trademarks or trade dress of Trex Company, Inc., Winchester, Virginia or its licensees.